

GABLE BRACE
FASTENED TO ALL
GABLE WEBS WITH #10
SD/ST SCREWS

PRE-ENG
COLD-FORMED
STEEL TRUSSES
SPACED AS PER
SPECIFICATIONS

HAT CHANNEL
STRAPPING

STUD ANGLE BRACE WITH
#10 SD/ST SCREWS IN EACH
CONNECTION. USE BEARING
CLIP AT BASE OF ANGLE
BRACE IN LOCATIONS WHERE
TRUSS WEBS NOT ALIGNED.

BOTTOM CHORD BRACING
(WHERE REQUIRED)

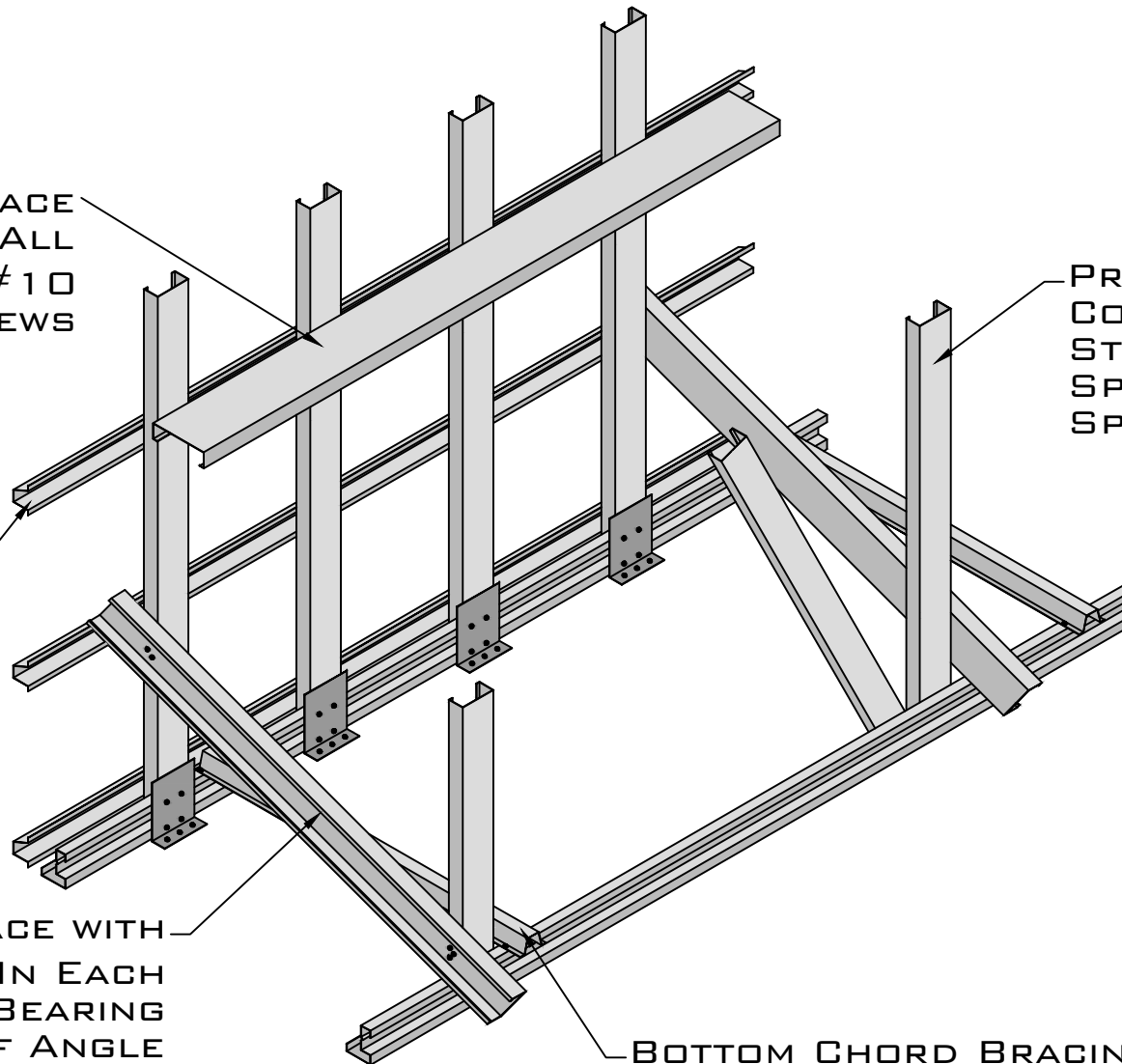

P: 1-877-251-6875
F: 1-866-873-0360
INFO@TRUSSES.CA



CFS TRUSS DETAILS -
GABLE END WIND
BRACING DETAIL