

STC 33 ASSEMBLY

- N.B.C.C. 2015 A-9.10.3.1.A. (F33A)
- 5/8" PLYWOOD
 - MIN. 8" CFS JOIST
 - 1 LAYER 5/8" TYPE X GYPSUM BOARD

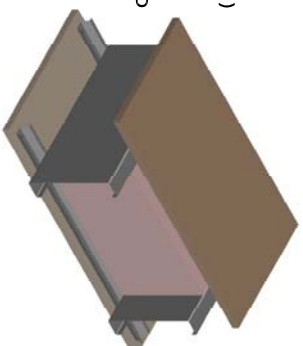

STC 41 / 30 MIN. ASSEMBLY

- N.B.C.C. 2015 A-9.10.3.1.A. (F41G)
- 5/8" PLYWOOD
 - MIN. 8" CFS JOIST
 - 8" FIBREGLOSS INSULATION
 - RC1 CHANNEL 1 SIDE
 - 1 LAYER 5/8" TYPE X GYPSUM BOARD

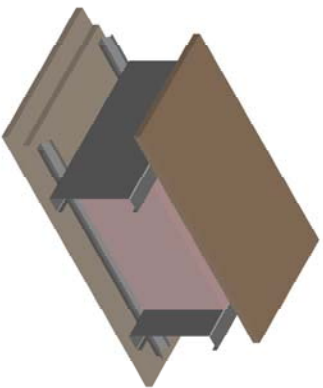

STC 54 / 1HR ASSEMBLY

- N.B.C.C. 2015 A-9.10.3.1.A. (F45C)
- 5/8" PLYWOOD
 - MIN. 8" CFS JOIST
 - 8" FIBREGLOSS INSULATION
 - RC1 CHANNEL 1 SIDE
 - 2 LAYERS 5/8" TYPE X GYPSUM BOARD

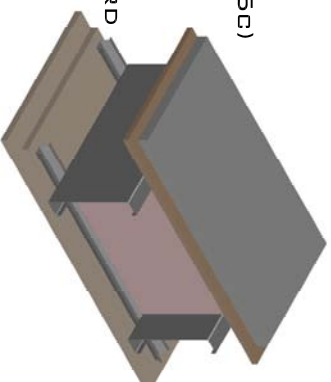

STC 69 / 1HR ASSEMBLY

- N.B.C.C. 2015 A-9.10.3.1.A. (F55C)
- 1 1/2" CONCRETE
 - 1/2" PLYWOOD
 - MIN. 8" CFS JOIST
 - 8" FIBREGLOSS INSULATION
 - RC1 CHANNEL 1 SIDE
 - 2 LAYERS 5/8" TYPE X GYPSUM BOARD

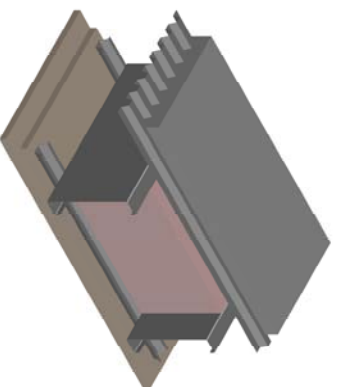

STC 69 / 1HR ASSEMBLY

- N.B.C.C. 2015 A-9.10.3.1.A. (F59C)
- 2" CONCRETE
 - 26 GA. METAL PAN WITH A 3/4" RIB
 - MIN. 8" CFS JOIST
 - 8" FIBREGLOSS INSULATION
 - RC1 CHANNEL 1 SIDE
 - 2 LAYERS 5/8" TYPE X GYPSUM BOARD

P: 1-877-251-6875
 F: 1-866-873-0360
 INFO@TRUSSES.CA



SOUND RATED
 FLOOR/ROOF
 ASSEMBLIES